

HARDANGER ANGEL ORNAMENT

DESIGNED BY RUTH HANKE OF HANKY PANKY DESIGNS

Materials needed:

- 6-inch square of 24-count white Congress Cloth
- two skeins of Silk Mori 8000 Soft White
- #24, #26 Tapestry needles
- large Mother of Pearl star *
- two 2mm joined beads (about three inches) *
- eight white glass seed beads *
- beading needle and white sewing thread
- tacky glue and Fray Check™

Read through all directions before starting project.

Directions:

Cut desired thread length and pull out one strand at a time and then recombine for stitching.

1. **BODY.** Start 1 3/4" from left and 2" from top of Congress Cloth with three strands of Silk Mori 8000 and work buttonhole (also known as blanket stitch) all around (area B on graph). Work Kloster blocks with two strands Silk Mori 8000 (area A on graph). Work backstitches across the bodice area (dotted lines on graph) with two strands of Silk Mori 8000.

2. Stitch eyelets (represented on the graph as dots), and woven bars with picots with one strand Silk Mori 8000.

3. Cut and remove threads to work buttonhole stitch star with two strands of Silk Mori 8000. Center web is created using one strand. (Area W on graph)

4. For the halo, sew or tack ends of joined white beads to back sides of head using white sewing thread, making sure that a nice circle rises above the angel head.

1. **WINGS.** Work buttonhole stitch all around using three strands of Silk Mori 8000 (area B), and satin stitch Kloster Blocks (area A) with two strands of Silk Mori 8000.

2. Eyelets are stitched with one strand of Silk Mori 8000 (dots on graph).

3. Cut and remove threads as marked on chart, and work woven bars with picots using one strand Silk Mori 8000 (area M).

4. Use sewing thread and needle to sew four white glass seed beads to wings as shown on wing graph.

CUTTING OUT ANGEL. Use a sharp scissor to cut out shapes staying away 2 threads of fabric all around outside edge. Use a tapestry needle to pull out threads that can be removed. Fray Check all around back edge of stitched pieces and let dry. Use small sharp

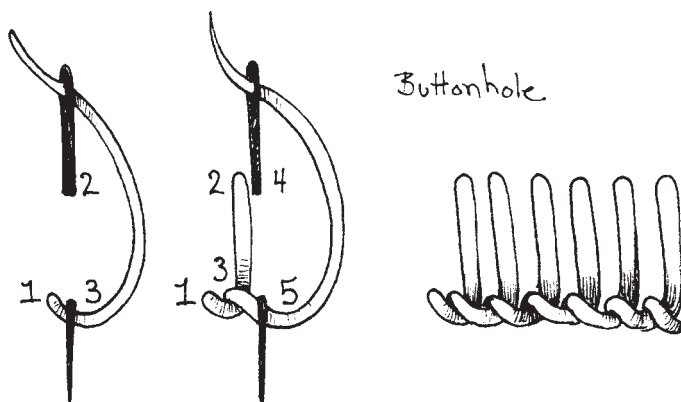

Diagonal Kloster Blocks

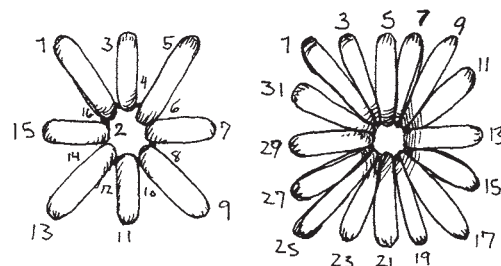
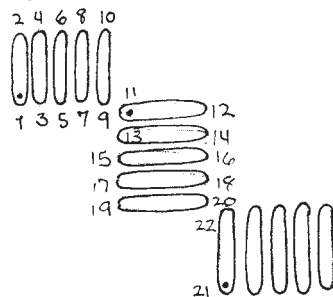

Algerian Eyelet

scissor to cut off remaining fabric threads from edges.

ARMS. Braid three bundles of complete strands of Silk Mori 8000 (all six strands) loosely until you have 4-inch length of braid. Glue ends of braid to secure and let dry. Sew ends of braid to back of sleeves making braided arms angle downward. Sew large star in center of braided circle in front.

Glue wings to back of angel. Sew a loop on the top back of ornament as a hanging loop.

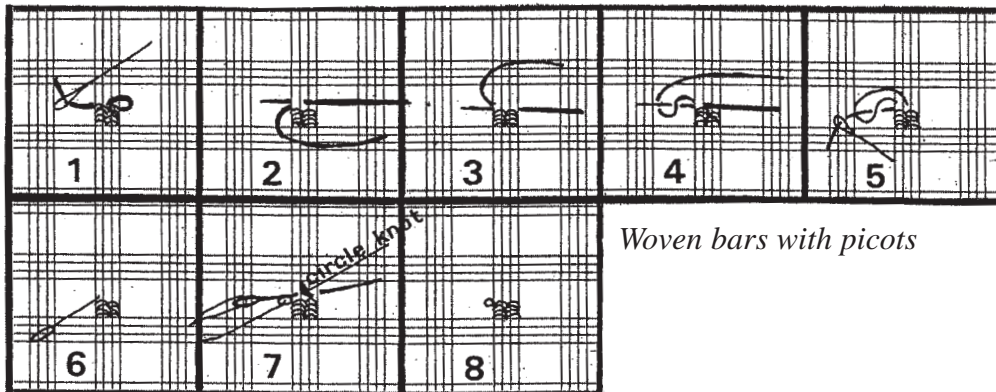

Woven bars with picots

© Copyright 2003 Kreinik. All rights reserved.

** Mother of Pearl star, string of beads, and seed beads can be found at craft stores or sewing stores.*

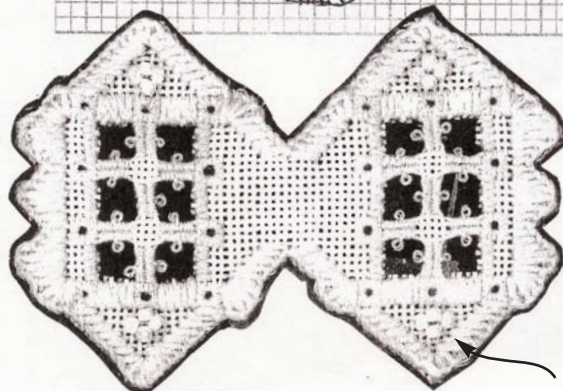
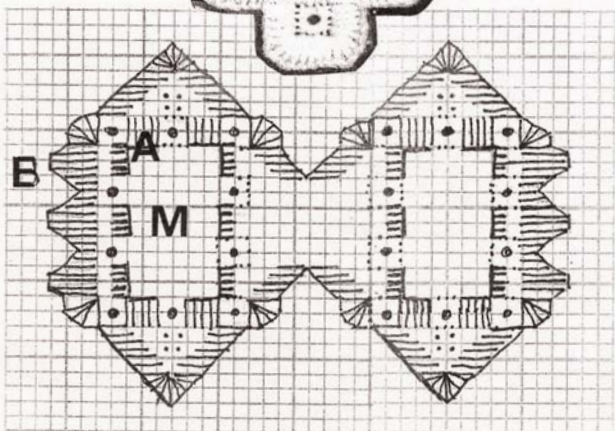
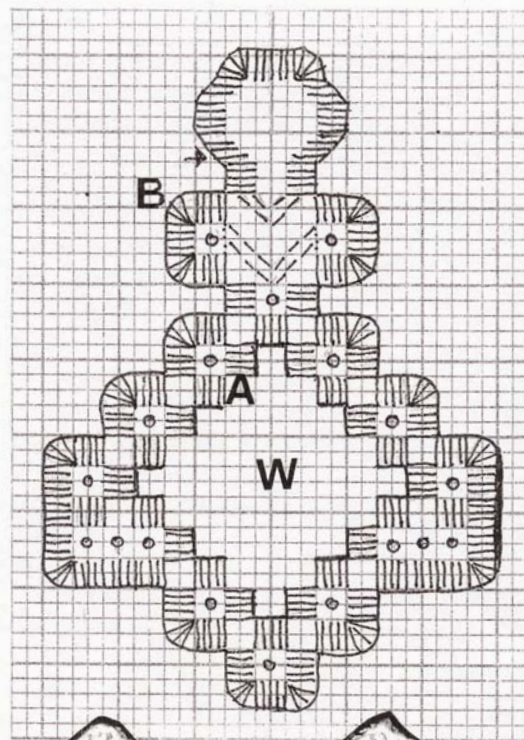
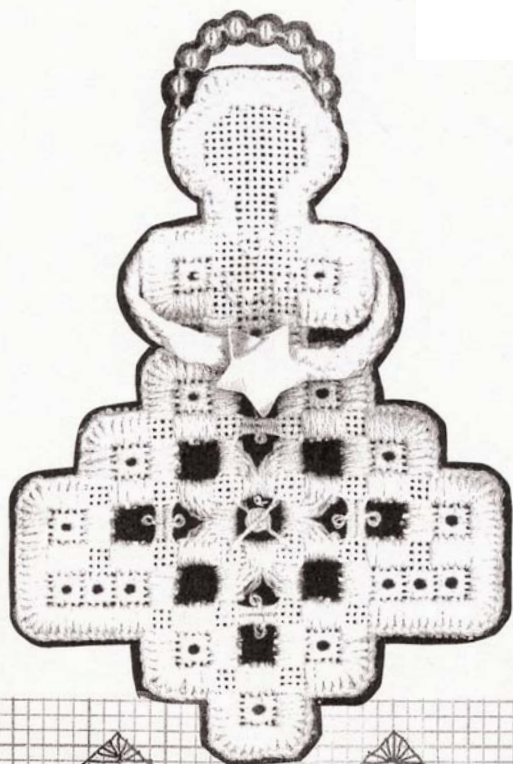

Beads